

# Longmead Avenue

## BISHOPSTON

APPROXIMATE FLOOR AREA  
94 SQM / 1011 SQFT



GROUND FLOOR



FIRST FLOOR

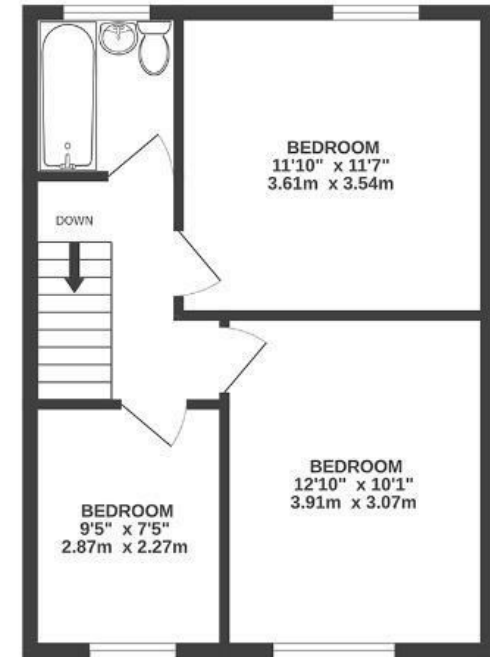

Boardwalk

# Longmead , BRISTOL

£

£600,000



BS7 8QQ

z z z

3 Bedrooms



1 Bathrooms

*"We have enjoyed spending time in our lovely big garden, it's been such a pleasure over the years watching the children run around, growing our own vegetables and basking in the sun."*

